



Personal Protective Equipment



Connecting Welding, Creating Value...
Welding & Cutting Technology



CONTENTS

● Personal Protective Equipment Profile	2-3
● Flame Retardant Welding Hood	4-6
● Colorful Cotton Cap	6-8
● Welding Helmet	9-15
● Welding Goggles Profile	16-17
● Welding Goggles	18-19
● Laser Safety Glasses	20-21
● Welding Clothing Profile	22-23
● Welder Protective Clothes	24-26
● Welding Bib Apron	27-28
● Welding Leather Sleeves	29-30
● Welding Glove	30-35
● Welding Curtain Profile	36-38
● Welding Curtains	39-41
● Laser safety room	42-43
● Welding Blanket Profile	44-46
● Welding Blanket	47
● Welding Fume Extractors Profile	48-51
● Welding Fume Extractors Quick Start Guide	52-53
● Welding Fume Extractors	54-61
● Welding Fume Arm	62
● Welding Fume Extractors Accessory	63
● Welding Downdraft Table Profile	64-66
● Welding Downdraft Table	67-69



PPE Including as Below

- Head and eyes protection includes welding helmet, goggles, safety glasses, face shield and welding cap, those will protect welders from radiation, flying particles, debris, hot slag, sparks, intense light, irritation and chemical burns.
- Lungs (breathing) protection includes PAPR, it will protect welders from fumes and oxides.
- Body protection includes welding cloth, welding jacket, welding pants, welding apron and bibs, those will protect welders from heat, fires, burns and radiation.
- Feet and hands protection includes welding gloves, welding sleeves, leggings and welding boots, those will protect welders from electric shock, heat, burns and fires.
- Ears hearing protection includes fire resistant ear muffs and ear plugs, those will protect welders from noise.

Personal Protective Equipment Profile

It commonly referred to as “PPE”, is protection from hazards that cause serious workplace injuries and illnesses, such as metal spatter, heat slogs, lighting and chemical smoke etc.

Welding is an activity in hazardous working condition, it will expose many workers to health and safety risks every year in the world. Physical hazards that can cause burns, eyes damage, cuts, crushed toes and fingers during welding. Welding physical safety products are protected welders from physical welding hazards,



Flame Retardant Welding Turban

PPE-WT-001

Features

- The style is sweat-absorbent, comfortable and stylish.
- Dust-proof, brazing welds to bind hair, reducing hair exposure to sparks.
- The welding helmet series is made of cotton cloth and is resistant to spatter.
- Ensure safe operation and stylish and cool, sweat-absorbent, comfortable and stylish.
- Head circumference 56cm.



PPE-WT-002

Features

- The style is sweat-absorbent, comfortable and stylish.
- Dust-proof, brazing welds to bind hair, reducing hair exposure to sparks.
- The welding helmet series is made of cotton cloth and is resistant to spatter.
- Ensure safe operation and stylish and cool, sweat-absorbent, comfortable and stylish.
- Head circumference 56cm.



PPE-WT-003

Features

- The style is sweat-absorbent, comfortable and stylish.
- Dust-proof, brazing welds to bind hair, reducing hair exposure to sparks.
- The welding helmet series is made of cotton cloth and is resistant to spatter.
- Ensure safe operation and stylish and cool, sweat-absorbent, comfortable and stylish.
- Head circumference 56cm.



PPE-WT-004

Features

- The style is sweat-absorbent, comfortable and stylish.
- Dust-proof, brazing welds to bind hair, reducing hair exposure to sparks.
- The welding helmet series is made of cotton cloth and is resistant to spatter.
- Ensure safe operation and stylish and cool, sweat-absorbent, comfortable and stylish.
- Head circumference 56cm.



Colorful Cotton Cap

PPE-Cap-001

Features

- The welding helmet is made of sportswear mesh with breathable mesh that is not stuffy, which effectively prevents the sweat generated by the head from coming into contact with the outside during work, and plays a role in fresh, breathable and comfortable head.
- The larger, faster sponge inner cushion sweatband can be used for most different types of neck widths, and is uniquely designed.
- Washable.
- Head circumference 56cm.



PPE-Cap-002

Features

- The welding helmet is made of sportswear mesh with breathable mesh that is not stuffy, which effectively prevents the sweat generated by the head from coming into contact with the outside during work, and plays a role in fresh, breathable and comfortable head.
- The larger, faster sponge inner cushion sweatband can be used for most different types of neck widths, and is uniquely designed.
- Washable.
- Head circumference 56cm.



PPE-Cap-003

Features

- The welding helmet is made of sportswear mesh with breathable mesh that is not stuffy, which effectively prevents the sweat generated by the head from coming into contact with the outside during work, and plays a role in fresh, breathable and comfortable head.
- The larger, faster sponge inner cushion sweatband can be used for most different types of neck widths, and is uniquely designed.
- Washable.
- Head circumference 56cm.



PPE-Cap-004

Features

- The welding helmet is made of sportswear mesh with breathable mesh that is not stuffy, which effectively prevents the sweat generated by the head from coming into contact with the outside during work, and plays a role in fresh, breathable and comfortable head.
- The larger, faster sponge inner cushion sweatband can be used for most different types of neck widths, and is uniquely designed.
- Washable.
- Head circumference 56cm.



PPE-Cap-005

Features

- The welding helmet is made of sportswear mesh with breathable mesh that is not stuffy, which effectively prevents the sweat generated by the head from coming into contact with the outside during work, and plays a role in fresh, breathable and comfortable head.
- The larger, faster sponge inner cushion sweatband can be used for most different types of neck widths, and is uniquely designed.
- Washable.
- Head circumference 56cm.



PPE-Cap-006

Features

- The welding helmet is made of sportswear mesh with breathable mesh that is not stuffy, which effectively prevents the sweat generated by the head from coming into contact with the outside during work, and plays a role in fresh, breathable and comfortable head.
- The larger, faster sponge inner cushion sweatband can be used for most different types of neck widths, and is uniquely designed.
- Washable.
- Head circumference 56cm.



Flame Retardant Welding Hood

PPE-Hood-001

Features

- Flame Retardant fabric for the outer shell, prevents flame and welding spatter.
- Cotton mesh lining by seams concealed, keep the inner ventilate and comfortable.
- Quickly around neck with Velcro straps.
- Add Velcro straps and buckle outside, easy to equip other safety helmet and mask.
- Head circumference 41cm, 15cm neck shoulder drape. One size fits all.



PPE-Hood-002

Features

- The outer layer is made of washable fireproof and flame retardant cloth.
- The inner layer is equipped with a heat dissipation net, which is breathable and cool.
- Unique bone position suture, comfortable to use.
- It is equipped with a unique lightweight velcro buckle design, which is convenient for use with various types of industrial helmets.



PPE-Hood-003

Features

- The outer shell of this shield is made of side split cowhide leather.
- Cotton mesh lining by seams concealed to keep inner ventilate and comfortable.
- Sewn with Dupont KAVLER thread.
- Velcro closure for adjustable & snug fit.
- Hood height 27cm, 20cm neck shoulder drape.



Components of Welding Face Shield and Welding Helmet

- Helmet shell
- Outer cover plate
- Filter lens
- Clear retainer lens
- Gasket
- Harness

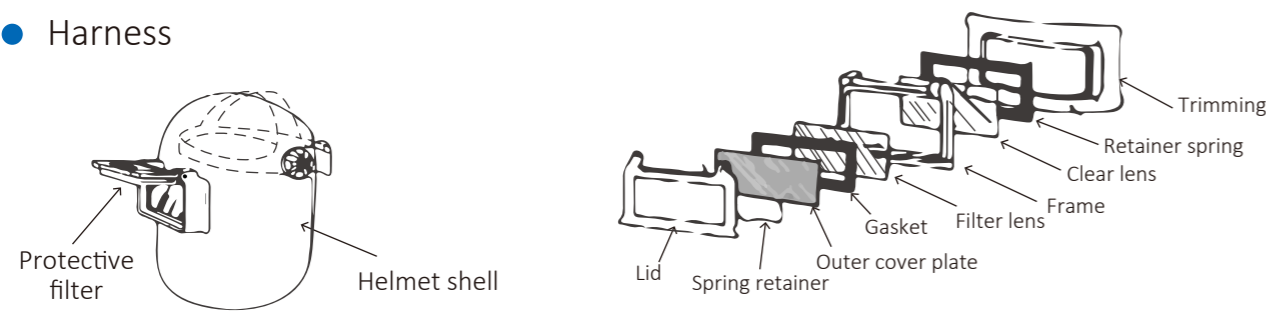

Filter Shade Selection

The suitable filter shade is selected according to welding process, wire diameter, welding current during welding.

Process	Electrode or wire diameter(mm)	Operation current(A)	Minimum Shade	Recommended Shade
MMA	<2.5	<60	7	-
	2.5-4	60-160	8	10
	4-6.4	160-250	10	12
	>6.4	250-550	11	14
MIG	0.6-1.6	<60	7	-
TIG	1.6-3.2	60-160	10	11
SUBMERGED ARC	1.6-2.4	160-250	10	12
FLUX-CORED	1.1-1.6	250-550	10	14
Air carbon	6-10	<500	10	12
Cutting	4-10	500-100	11	14

The recommended shade numbers for oxygen cutting:

Process	Metal thickness (mm)	Minimum Shade	Recommended Shade
Light	<25	3	4
Medium	25-150	4	5
Heavy	>150	5	6

STRUCTURAL GRAPH

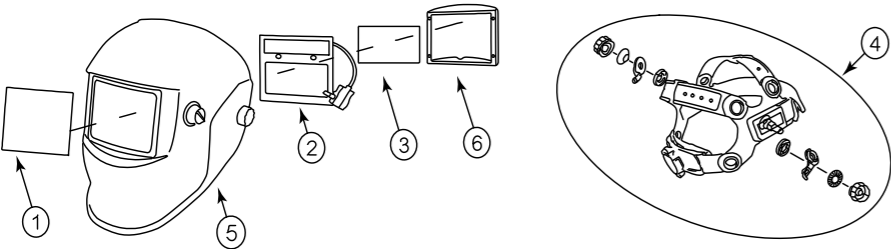

1. Front cover lens
2. ADF cartridge
3. Inside cover lens
4. Headgear assembly
5. Helmet shell
6. ADF holder

PPE-Helmet-001/002



Features

- Premium Arc Sensors: This product builds two arc sensors inside, each sensor can work independently and detect welding arcs easily. The arc sensor focuses on the welding arcs without any interference from surroundings.
- Comfortable and Lightweight Welding Helmet: Adjustable headgear for maximum comfort. High-impact resistance material, lightweight and durable.
- Shade/Sensitivity/Delay Time Stepless Adjustment: Knob design with clear interface, you can easily adjust control knob to achieve shade, delay time from 0.1 to 1 seconds, sensitivity from low to high level.
- Pivot Headgear Design: Adjustable pivot headgear, well-balanced design, maximum comfortable feelings, lock function in upright state.

Modle	PPE-Helmet-001	PPE-Helmet-002
Optical Class	1/1/1/2 or 1/1/1/1	1/1/1/2 or 1/1/1/1
Cartridge Size	110mmx90mmx9mm	110mmx90mmx9mm
Viewing Area	92.5x42.5mm(3.64"x1.67")	92.5x42.5mm(3.64"x1.67")
Light State	DIN3.5	DIN3.5
Dark State	DIN9~13	DIN9~13
Shade Control	External & Stepless	External & Stepless
Switching Time	3/10000S+20%	3/10000S+20%
Sensitivity Control	Internal & Stepless	Internal & Stepless
Delay Time	0.1S~1S	0.1S~1S
Power supply	Li-battery & Solar	Li-battery & Solar
Rated Capacity Of Li-Battery	600mAh	600mAh
Replaceable Battery	No	Yes
Operating Temp.	-5℃~55℃	-5℃~55℃
Storing Temp.	-20℃~70℃	-20℃~70℃
Arc Sensor	2	2
Low Amperage TIG Rated	≥5amps	≥5amps
Helmet Material	PP Or PA	PP or PA
UV/IR Protection	DIN13	DIN13
Test	No	Yes
Low Battery	No	Yes
Grinding	No	Yes
Cutting	No	NO
LED	No	No

PPE-Helmet-003/004



Features

- Premium Arc Sensors: This product builds four arc sensors inside, each sensor can work independently and detect welding arcs easily.The arc sensor focuses on the welding arcs without any interference from surroundings.
- Comfortable and Lightweight Welding Helmet: Adjustable headgear for maximum comfort.High-impact resistance material, lightweight and durable.
- Shade Range 5-9/9-13: For most welding/cutting applications, also including grinding mode.
- Highest Optical Class 1/1/1/1: Top quality ADF lens, optical class: 1/1/1/1, which can provide ultra-clear view and best protection for users’ eyes.
- High Resolution Lens Technology: High resolution lens technology brings high-definition visual experience, increases eyes comfort, and reduces fatigue greatly, especially for long time welding job in Industrial field.

Modle	PPE-Helmet-003	PPE-Helmet-004
Optical Class	1/1/1/2 or 1/1/1/1	1/1/1/2 or 1/1/1/1
Cartridge Size	124.5mmx100.5mmx18mm	133mmx114mmx10mm
Viewing Area	92.5x42.5mm(3.64"x1.67")	100x59.5mm(3.94"x2.34")
Light State	DIN3.5	DIN3.5
Dark State	DIN5~9/9~13	DIN5~9/9~13
Shade Control	External & Stepless	Internal & Stepless
Switching Time	3/10000S+20%	1/10000S+20% or 1/25000S+20%
Sensitivity Control	External & Stepless	Internal & Stepless
Delay Time	0.1S /0.4S /1S	0.1S~1S
Power supply	Li-battery & Solar	Li-battery & Solar
Rated Capacity Of Li-Battery	1200mAh	1200mAh
Replaceable Battery	Yes	Yes
Operating Temp.	-5℃~55℃	-5℃~55℃
Storing Temp.	-20℃~70℃	-20℃~70℃
Arc Sensor	2	4
Low Amperage TIG Rated	≥5amps	≥5amps
Helmet Material	PA/PP	PA/PP
UV/IR Protection	DIN13	DIN13
Test	Yes	Yes
Low Battery	Yes	Yes
Grinding	Yes	Yes
Cutting	Yes	Yes
LED	No	No

PPE-Helmet-005/006



Features

- Premium Arc Sensors: This product builds four arc sensors inside, each sensor can work independently and detect welding arcs easily.The arc sensor focuses on the welding arcs without any interference from surroundings.
- Comfortable and Lightweight Welding Helmet: Adjustable headgear for maximum comfort.High-impact resistance material, lightweight and durable.
- Shade/Sensitivity/Delay Time Stepless Adjustment: Knob design with clear interface, you can easily adjust control knob to achieve shade, delay time from 0.1 to 1 seconds, sensitivity from low to high level.
- Shade Range 5-9/9-13: For most welding/cutting applications, also including grinding mode.
- Highest Optical Class 1/1/1/1: Top quality ADF lens, optical class: 1/1/1/1, which can provide ultra-clear view and best protection for users’ eyes.

Modle	PPE-Helmet-005	PPE-Helmet-006
Optical Class	1/1/1/2 or 1/1/1/1	1/1/1/2 or 1/1/1/1
Cartridge Size	133mmx114mmx10mm	133mmx114mmx10mm
Viewing Area	100x83mm(3.94"x3.27")	100x93mm(3.94"x3.66")
Light State	DIN3.5	DIN3.5
Dark State	DIN5~9/9~13	DIN5~9/9~13
Shade Control	External & Stepless	External & Stepless
Switching Time	1/10000S+20% or 1/25000S±20%	1/10000S+20% or 1/25000S+20%
Sensitivity Control	Internal & Stepless	Internal & Stepless
Delay Time	0.1S~1S	0.1S /0.4S /1S
Power supply	Li-battery & Solar	Li-battery & Solar
Rated Capacity Of Li-Battery	600mAh	600mAh
Replaceable Battery	Yes	Yes
Operating Temp.	-5℃~55℃	-5℃~55℃
Storing Temp.	-20℃~70℃	-20℃~70℃
Arc Sensor	4	4
Low Amperage TIG Rated	≥5amps	≥5amps
Helmet Material	PA/PP	PA/PP
UV/IR Protection	DIN13	DIN13
Test	Yes	Yes
Low Battery	Yes	Yes
Grinding	Yes	Yes
Cutting	Yes	Yes
LED	NO	NO

PPE-Helmet-007/008



Features

- Premium Arc Sensors: This product builds four arc sensors inside, each sensor can work independently and detect welding arcs easily.The arc sensor focuses on the welding arcs without any interference from surroundings.
- Comfortable and Lightweight Welding Helmet: Adjustable headgear for maximum comfort.High-impact resistance material, lightweight and durable.
- Shade/Sensitivity/Delay Time Stepless Adjustment: Knob design with clear interface, you can easily adjust control knob to achieve shade, delay time from 0.1 to 1 seconds, sensitivity from low to high level.
- Shade Range 5-9/9-13: For most welding/cutting applications, also including grinding mode.
- LED Lighting: In case of low ambient light, the welding helmet can automatically turn on the LED light.

Modle	PPE-Helmet-007	PPE-Helmet-008
Optical Class	1/1/1/2 or 1/1/1/1	1/1/1/2 or 1/1/1/1
Cartridge Size	153.5mmx120.5mmx42mm	133mmx114mmx10mm
Viewing Area	109.5x97mm(4.31"x3.82")	100x93mm(3.94"x3.66")
Light State	DIN3.5	DIN3.5
Dark State	DIN5~9/9~13	DIN5~9/9~13
Shade Control	External & Stepless	External & Stepless
Switching Time	1/10000S+20% or 1/25000S+20%	1/10000S+20% or 1/25000S±20%
Sensitivity Control	External & Stepless	External & Stepless
Delay Time	0.1S~1S	0.1S~1S
Power supply	Li-battery & Solar	Li-battery & Solar
Rated Capacity Of Li-Battery	300mAh Rechargeable	600mAh
Replaceable Battery	No	Yes
Operating Temp.	-5℃~55℃	-5℃~55℃
Storing Temp.	-20℃~70℃	-20℃~70℃
Arc Sensor	4	4
Low Amperage TIG Rated	≥5amps	≥5amps
Helmet Material	PA/PP	PA/PP
UV/IR Protection	DIN13	DIN13
Test	Yes	Yes
Low Battery	Yes	Yes
Grinding	Yes	Yes
Cutting	Yes	Yes
LED	yes	NO

PPE-Helmet-009



Features

- Premium Arc Sensors: This product builds four arc sensors inside, each sensor can work independently and detect welding arcs easily.The arc sensor focuses on the welding arcs without any interference from surroundings.
- Shade Range 5-9/9-13: For most welding/cutting applications, also including grinding mode.
- High Resolution Lens Technology: High resolution lens technology brings high-definition visual experience, increases eyes comfort, and reduces fatigue greatly, especially for long time welding job in Industrial field.
- Flip up Design: Easy to lift up for grinding function, safer and clearer.
- Side Window: Shade 5 lens on both sides, enhance surrounding vision, safer and securer.

Modle	PPE-Helmet-009
Optical Class	1/1/1/2 or 1/1/1/1
Cartridge Size	120mmx115mmx10mm
Viewing Area	100x59.5mm(3.94"x2.34")
Light State	DIN3.5
Dark State	DIN5~9/9~13
Shade Control	Internal, Digital Control
Switching Time	1/10000S+20% or 1/25000S+20%
Sensitivity Control	Digital Control
Delay Time	0.1S ~1S, Digital Control
Power supply	Li-battery & Solar
Rated Capacity Of Li-Battery	300mAh Rechargeable
Replaceable Battery	NO
Operating Temp.	-5℃~55℃
Storing Temp.	-20℃~70℃
Arc Sensor	4
Low Amperage TIG Rated	≥5amps
Helmet Material	PP or PA
UV/IR Protection	DIN13
Test	NO
Low Battery	Yes
Grinding	Yes
Cutting	Yes
LED	NO

PPE-Helmet-010



Overview

- Fashionable and Ergonomic Design.
- Fast and Easy Replacement of Lens.
- Protection From Sparks and Splash.
- High Impact Resistance PC Lens.
- Anti-scratch Lens.

Features

- High Intensity of PC Lens with Secure Feature: Non-deformation PC lens, with better optical performance, bringing high-resolution and vision experience.
- Excellent 3D structure design: Meeting ergonomically designed, to better fit face-line and optimize wearing comfort.
- Anti-scratch Lens: Effectively preventing excessive spark and splash damages.

Modle		PPE-Helmet-010
Size of Window (HeightxWidthxThickness)	Full-face Window	209x230x2mm
	Flip Window	
Dark State	Full-face Window	Transparent
	Flip Window	
UV/IR Protection	Full-face Window	
	Flip Window	
Grinding		Yes
Welding		No
Cutting		No
Weight		310g

PPE-Helmet-011/012



Overview

- Fashionable and Ergonomic Design
- Fast and Easy Replacement of Lens
- Protection From Sparks and Splash
- High Impact Resistance PC Lens
- Anti-scratch Lens
- Protection against UV/IR

Features

- High Intensity of PC Lens with Secure Feature: Non-deformation PC lens, with better optical performance, bringing high-resolution and vision experience.
- Protection against UV/IR: With superior feature of heat resistance and high-impact.
- Excellent 3D structure design: Meeting ergonomically designed, to better fit face-line and optimize wearing comfort.
- Anti-scratch Lens: Effectively preventing excessive spark and splash damages.

Modle		PPE-Helmet-011
Size of Window (HeightxWidthxThickness)	Full-face Window	209x230x2mm
	Flip Window	
Dark State	Full-face Window	DIN3
	Flip Window	
UV/IR Protection	Full-face Window	DIN3
	Flip Window	
Grinding		Yes
Welding		Yes
Cutting		Yes
Weight		310g

Modle	PPE-Helmet-012-A		PPE-Helmet-012-B	
Type	Laser Welding Helmet		Laser Welding Helmet	
Size of Window	209x230x3mm		209x230x3mm	
VLT	13% or 5% or 2%		13% or 5% or 2%	
Wavelength Range	190~380nm	900~1100nm	190~380nm	900~1100nm
Optical Density	OD8	OD8	OD8	OD8
Material	PC、ABS、PA、PE		PC、ABS、PA、PE	
Net Weight	470g		625g	
Aut-off Laser	NO		Yes	



How to Choose Eye Protection Products

- Arc welding, air plasma cutting and gouging are required full fact protection by using welding helmet and hand shield.
- The light intensity of gas cutting or brazing is much less than from arc welding, plasma cutting and gouging processes, light shade filter lenses can be used with goggles instead of a welding helmet.

Why the Eyes Protection Important

Eyes hazards can occur from the intense light and radiation which are produced by welding arc. Eye hazards could also occur from hot slag or other metal debris which can fly off from welding, cutting, gouging and grinding.

How to Protect Eyes From Welding Hazards

- Protect eyes from welding light by wearing welding helmet fitted with a filter shade which is suitable for the welding process you are doing.
- Always wear safety glasses with side shields or goggles during welding, cutting, gouging if you are not wearing a welding helmet.

PPE-Goggles-001/002



Modle	PPE-Goggles-001	PPE-Goggles-002
The type of power supply	solar energy	solar energy
Frame group size(mm)	108*50	108*50
Window size(mm)	90*30	90*30
Brightness level	DIN3	DIN3
Dark state level	DIN11	DIN11
Dark-state moderation	self-regulation	self-regulation
Variable light response time	1/10000S	1/10000S
Recovery time	0.1-0.8s	0.1-0.8s
Arc sensors	2	1
Sensing sensitivity	No	No
Delay adjustment	No	No
Operating temperature(°C)	-10~65 °C	-10~65 °C
Volume warning	No	No
True color lenses	Yes	Yes
Face shield material	PP	PP
Weight(g)	70	60

Laser Safety Glasses

PPE-Goggles-003

- Optical Density: 740 - 780nm OD>5/780 - 820nm OD>6/ 820 - 1100nm OD>7
- LB-Rating: 740-780nm DIR LB5780-820nm DLB5+IR LB6/>820-1080nm DLB5+IR LB7
- Transmittance: 33%
- Available for: 755nm, 808nm, 980nm,1064nm etc.,
- Application: Alexandrite, Diodes, ND: YAG



PPE-Goggles-004

- Optical Density: 800 - 1700nm OD4+ / 900 - 1550nm OD6+
- LB-Rating: 800 - 1400nm DIRM LB4 / 900 - 1400nm DIRM LB6 / 1400 - 1700nm DI LB3
- Transmittance: 18%
- Available for: 980nm, 1064nm, 1320nm, 1470nm, 1550nm etc.,
- Application: Diodes, ND: YAG, Telecom



PPE-Goggles-005

- Optical Density: 180 - 532nm OD5+ / 900 - 1080nm OD5+
- LB-Rating: 316 - 532nm DIRM LB5 / 900 - 1080nm DIR LB5
- Transmittance: 22%
- Available for: 532nm & 1064nm etc.,
- Application: 2 line YAG and KTP, Q-Switched





Type of Welding Clothing

- **Welding jackets**
Jackets cover the arms and torso, extending to the hip, they also cover the arms. Half jackets did not cover the back.
- **Welding Bibs**
Welding bibs are strapped around the neck, bibs cover the lower neck and upper chest, but do not cover anywhere else.
- **Welding pants**
Pants cover the legs and secured by integrated belts. Pants usually accommodate a variety of waistlines, but the length is in standard size.
- **Welding sleeves**
Sleeves cover the arms. It provides protection in low volume welding process.
- **Welding boots**
Boots cover and protect the feet, boots size can be ordered footwear dimensions.
- **Welding aprons**
Welding aprons are not typically sized, but offer standard length with adjustable neck straps. Aprons cover the chest to the knee, but do not cover shoulders or arms.
- **Welding caps**
Welding caps cover the forehead, caps can not replace the welding helmet, but they are useful together with goggles. Caps are rarely made of leather.
- **Welding gloves**
Glovers cover hands, size can be M, L or XL.
- **Welding Leggings**
Leggings cover the shins only, denim is the most common material for leggings, they usually have a fastening mechanism such as a spring-loaded strap or Velcro.

Welding Clothing Profile

Welding clothing is one type of personal protective equipment (PPE) used to protect welders from sparks, metal spatters, slag and high heat by using fire resistant and thermally insulation materials. Welding clothing will cover all areas of exposed skin, such as welding jacket, pants, gloves, boots, cap, bibs and so on.

Material of Welding Clothing

Fabric of material should be heavy cotton or wool, rubber or leather, the best material of welding clothing includes as below,

- **Denim**
Denim is a thick, rugged material that will protect welders from working condition that are low in volume and intensity.

- **Leather**
Welding leather clothing is made from premium heavy side split cow leather. It is soft and durable while resisting heat, sparks, slag. All seams are sewn with Kevlar thread.
- **Rubber**
Rubber is not a material typical for welding clothing, such as jackets, caps, pants, but it can be used in welding boots and boots cover.
- **Cotton**
Fire resistance cotton fabric has been chemically treated to withstand heat, it provides economical protection from flame, sparks and molten splash. Cotton clothing are breathable, lightweight comparing to leather. Material remains flame resistant for up to 50 washings.
- **Carbon fiber**
Carbon fibers are renowned for their high-temperature utility when combined with graphite and these clothing articles must undergo processes to make the clothing less stiff.

Welder Protective Clothes

PPE-Apron-001

- Made of select split cowhide for maximam durability and heavy duty protection.
- Sewn with KEVLAR stitches.
- Flap pocket for personal items and keep safe.
- Unique self-balancing strap system features a quick-release buckle and sliding length neck waist adjuster.



SPECIFICATIONS

Model	ERP	Sizes	Color
PPE-Apron-001	00.1358.06	L / XL / XXL	Golden yellow

PPE-Apron-002

- Split cowhide for maximum durability and heavy duty protection.
- Sewn with strength and flame retardant Dupont KEVLAR thread.
- Equipped 2.5cm width cotton sliding length adjuster with quick-release buckle of the back.
- Feature an open back design that offers cool comfort under indoor or hot climate conditions.



SPECIFICATIONS

Model	ERP	Sizes	Color
PPE-Apron-002	00.1358.05	L / XL / XXL / XXXL	Golden yellow

PPE-Apron-003

- Split cowhide for maximum durability and heavy duty protection.
- Sewn with KEVLAR stitches.
- Equipped 2.5cm width cotton sliding length adjuster with quick-release buckle of the back.
- Feature an open back design that offers cool comfort under indoor or hot climate conditions.



SPECIFICATIONS

Model	ERP	Sizes	Color
PPE-Apron-003	00.1358.04	L / XL / XXL	Golden yellow

PPE-Apron-004

- Made of select split cowhide for maximam durability and heavy duty protection.
- Sewing with strength and flame retardant Dupon Kavlar spread.



SPECIFICATIONS

Model	ERP	Length	Color
PPE-Apron-004	00.0020.04	61 cm	Golden yellow

PPE-Jacket-001

- Side split cowhide leather.
- Sewn with KEVLAR stitches.
- Insulated snaps front for joint.
- Adjustable cuff for better fit and work. The cape sleeves and bib could be jointed or seperated using.
- Fast release and adjustable buckle open back design for better fit.
- Adjustable waist for better fit when joined using.



SPECIFICATIONS

Model	ERP	Sizes	Color
PPE-Jacket-001	00.1358.02/00.1358.03	L / XL / XXL / XXXL	Golden yellow

PPE-Pant-001

- This welding chap is made of Belly cowhide leather.
- Sewn with KEVLAR stitches.
- Equipped sliding length adjuster with quick-release buckle on the waist/knees/crus.



SPECIFICATIONS

Model	ERP	Sizes	Color
PPE-Pant-001	00.0020.03	L / XL	Golden yellow

PPE-Sleeves-001

- Made of Split Cowhide Leather.
- Welding Sleeves with KEVLAR thread which for applications involving both material handling & welding.
- Concealed studs at wrist.
- Buckle balance on the back.
- Convenient scribe pockets.



SPECIFICATIONS

Model	ERP	Length	Color
PPE-Sleeves-001	00.0019.04	56cm	Golden yellow

PPE-Sleeves-002

- It is made of lightweight and flexible beef two-layer thin core leather, and has the functions of high temperature resistance, fire resistance, and splash resistance.
- Sewing with DuPont Kevlar fireproof thread, high durability.
- 48CM EXTRA-LONG DESIGN, WRIST CONFIGURATION DARK ELASTIC ELASTIC BAND.
- Adjustable velcro on the arm for added comfort.
- Easy and comfortable to use, suitable for the needs of various workplaces.



SPECIFICATIONS

Model	ERP	Length	Color
PPE-Sleeves-002	00.0019.02	48cm	Golden

PPE-Sleeves-003

- 11 oz. flame resistant cotton perfect protection for Arc welding.
- Short sleeves design.
- With KEVLAR thread which for applications involving both material handling & welding.
- Elastic on wrist & top for snug fit.



SPECIFICATIONS

Model	ERP	Length	Color
PPE-Sleeves-003	00.0019.03	48cm	Black

PPE-Boots-001

- Selected hard-wearing and insulated beef leather, sewn from DuPont Kevlar® fireproof thread.
 - Fitted and comfortable, the velcro fit is easy to wear, and the unique soft aluminum foil shaping device can adjust the size according to the actual situation.
- The important parts are fixed with willow nails, which is more firm and durable.
- Double-strip velcro for different leg sizes.
- Effectively prevent welding spatter



SPECIFICATIONS

Model	ERP	Length	Color
PPE-Boots-001	00.0020.02	15cm	Golden yellow

PPE-Boots-002

- Selected hard-wearing and insulated beef leather, sewn from DuPont Kevlar® fireproof thread.
- Fitted and comfortable, the velcro fit is easy to wear, and the unique soft aluminum foil shaping device can adjust the size according to the actual situation.
- The velcro fit is easy to wear.
- Effectively prevent welding spatter from injuring the foot.



SPECIFICATIONS

Model	ERP	Length	Color
PPE-Boots-002	00.0020.01	30cm	Golden yellow

PPE-Shield-001

- Aluminized PFR rayon outer shell reflects 95% of radiant heat.
- Split cowhide leather inner provides extra durability and heat resistant.
- Leather and elastic strap system provides excellent comfort.



SPECIFICATIONS

Model	ERP	Length	Color
PPE-Shield-001	00.0019.01	20cm*15cm	Golden yellow

PPE-Smock-001

- Cotton tooling, scratch and wear-resistant.
- Comfortable and breathable, strong tear resistance, and general spark splash resistance.
- Extra-large hidden security pocket for easy storage, security snap closure for privacy.



SPECIFICATIONS

Model	Sizes	Color
PPE-Smock-001	L - XXXXXL	Navy blue

Welding Glove

For MMA Welding

MMA Welding Glove (Yellow)

- Made of A-Grade Cowhide split leather
- Evenly soft and moderate leather
- Greater protection against sparks and abrasion
- Sewn with Kevlar thread
- Full palm and 100% cotton lining



SPECIFICATIONS

Model	ERP	Sizes	Color
CPG-7149	00.2712	ONE SIZE	Yellow

MMA Welding Glove (Blue)

- Made of A-Grade Cowhide split leather
- Evenly soft and moderate leather
- Greater protection against sparks and abrasion
- Sewn with Kevlar thread
- Full palm and 100% cotton lining



SPECIFICATIONS

Model	ERP	Sizes	Color
CPG-7142	00.2713	ONE SIZE	Blue

MMA Welding Glove (Grey)

- Made of A-Grade Cowhide split leather
- Evenly soft and moderate leather
- Greater protection against sparks and abrasion
- Sewn with Kevlar thread
- Full palm and 100% cotton lining



SPECIFICATIONS

Model	ERP	Sizes	Color
CPG-7140	00.2714	ONE SIZE	Grey

MMA Welding Glove (Golden)

- Made of A-Grade Cowhide split leather
- Evenly soft and moderate leather
- Greater protection against sparks and abrasion
- Sewn with Kevlar thread
- Full palm and 100% cotton lining



SPECIFICATIONS

Model	ERP	Sizes	Color
CPG-1210	00.2702.01	L	Golden
	00.2702.02	XL	

For MMA/MIG Welding

MMA/MIG Welding Glove (Black)

- Made of A-Grade Cowhide split leather
- Evenly soft and moderate leather
- Greater protection against sparks and abrasion
- Sewn with Kevlar thread
- Full palm and 100% cotton lining



SPECIFICATIONS

Model	ERP	Sizes	Color
CPG-0131	32.0131.01	ONE SIZE	Black

MMA/MIG Welding Glove (Blue)

- Made of A-Grade Cowhide split leather
- Evenly soft and moderate leather
- Greater protection against sparks and abrasion
- Sewn with Kevlar thread
- Full palm and 100% cotton lining



SPECIFICATIONS

Model	ERP	Sizes	Color
CPG-0132	32.0131.02	ONE SIZE	Blue

MMA/MIG Welding Glove (Blue)

- Made of A-Grade Cowhide split leather
- Evenly soft and moderate leather
- Greater protection against sparks and abrasion
- Sewn with Kevlar thread
- Full palm and 100% cotton lining



SPECIFICATIONS

Model	ERP	Sizes	Color
CPG-0160	00.2701.01	L	Blue
	00.2701.02	XL	

MMA/MIG Welding Glove (Blue)

- Made of A-Grade Cowhide split leather
- Evenly soft and moderate leather
- Greater protection against sparks and abrasion
- Sewn with Kevlar thread
- Full palm and 100% cotton lining



SPECIFICATIONS

Model	ERP	Sizes	Color
CPG-1201	00.1364.01	L	Blue
	00.1364.02	XL	

MMA/MIG Welding Glove (Orange)

- Made of A-Grade Cowhide split leather
- Evenly soft and moderate leather
- Greater protection against sparks and abrasion
- Sewn with Kevlar thread
- Full palm and 100% cotton lining



SPECIFICATIONS

Model	ERP	Sizes	Color
CPG-2102	00.2705.01	L	Orange
	00.2705.02	XL	

MMA/MIG Welding Glove (Grey)

- Made of A-Grade Cowhide split leather
- Evenly soft and moderate leather
- Greater protection against sparks and abrasion
- Sewn with Kevlar thread
- Full palm and 100% cotton lining



SPECIFICATIONS

Model	ERP	Sizes	Color
CPG-2112	00.2706.01	L	Grey
	00.2706.02	XL	

MMA/MIG Welding Glove (Grey)

- Made of A-Grade Cowhide split leather
- Evenly soft and moderate leather
- Greater protection against sparks and abrasion
- Sewn with Kevlar thread
- Full palm and 100% cotton lining



SPECIFICATIONS

Model	ERP	Sizes	Color
CPG-2201	00.1366.01	L	Grey
	00.1366.02	XL	

MMA/MIG Welding Glove (Golden)

- Made of A-Grade Cowhide split leather
- Evenly soft and moderate leather
- Greater protection against sparks and abrasion
- Sewn with Kevlar thread
- Full palm and 100% cotton lining



SPECIFICATIONS

Model	ERP	Sizes	Color
CPG-2202	00.1365.01	L	Golden
	00.1365.02	XL	

General Purpose

Work Glove (Grey)

- Cowhide split leather palm
- More durable Denim back
- Double stitched seam
- Comfortable cotton lining



SPECIFICATIONS

Model	ERP	Sizes	Color
CPG-2025	00.2715	ONE SIZE	Grey

Work Glove (Grey)

- Made of Cowhide split leather palm
- Split leather knuckle strip
- 3" rubberized safety cuff
- Shirred elastic wrist for snug fit
- Comfortable cotton lining



SPECIFICATIONS

Model	ERP	Sizes	Color
CPG-1525	00.2704.01	L	Grey
	00.2704.02	XL	

Work Glove (Grey)

- Made of Cowhide split leather palm
- Split leather knuckle strip
- 3" rubberized safety cuff
- Shirred elastic wrist for snug fit
- Comfortable cotton lining



SPECIFICATIONS

Model	ERP	Sizes	Color
CPG-2203	00.1618.01	L	Grey
	00.1618.02	XL	

General Purpose Glove (Golden)

- Cowhide split leather palm
- More durable Denim back
- Double stitched seam
- Comfortable cotton lining



SPECIFICATIONS

Model	ERP	Sizes	Color
CPG-1505	00.2703.01	L	Golden
	00.2703.02	XL	

General Purpose Glove (Golden)

- Cowhide split leather palm
- More durable Denim back
- Double stitched seam
- Comfortable cotton lining



SPECIFICATIONS

Model	ERP	Sizes	Color
CPG-1506	00.1615.01	L	Golden
	00.1615.02	XL	



Welding Curtain Profile

Welding curtain (Screen) & blankets protect surrounding people and your valuable equipment and property against unnecessary exposure to flame, spatter, heat and molten splash. Increase productivity by creating a cleaner, quieter, and safer workplace.

Welding curtain (Screens) are made with a specially formulated vinyl 0.4 mm thick. These screens are transparent and resistant to UV rays, flame, and abrasion.

Our production line incorporates ultrasonic weld technology. The ultrasonic technology actually fuses the hem and grommet, making them more structurally sound and durable than any other screen on the market.

Portable Welding Curtain

The most common welding shield.
The portable welding screens fold up and can be moved anywhere.



Welding Booth Curtains

Side to side vinyl curtains for welding booths.
Common at schools and colleges.

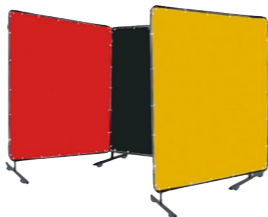

Welding curtain Walls

Welding curtains that form a wall or a complete
4 sided welding booth



Welding Curtain Rolls

Tinted and opaque welding rolls that zip tile to welding
cell fencing or for static hanging.



Strip Welding Curtains

Includes PVC strips & hardware for a complete weld
strip system. Available in all configurations, such as
hanging welding strips, freestanding welding strips,
welding booth strips, Robot strip curtains, exhaust
hood strip curtains, welding strip rolls and high heat
strip curtains.



Size of Welding Curtain

Usually, the height of curtain is 1.8m, width can be made according to
requirement, but the minimum width of curtain is 1.2m.

Welding Curtains

Welding Curtains

- Flame resistant
- UV resistant
- Waterproof
- Anti-mildew
- Slip resistant
- Scuff resistant
- Chemical resistant
- Color Fade resistant
- Phthalate free
- Airtight etc.
- EN ISO 25980 Approved
- 16mil (0.4mm) specially formulated vinyl



SPECIFICATIONS

Model	ERP	Sizes(W*H)	Color	Unit
CPC-0001	00.3796	1.74*1.74m	Orange	Each
CPC-0002	32.0148.01	2.0*1.8m	Orange	Each
CPC-0003	32.0148.02	2.7*1.8m	Orange	Each
CPC-0013	32.0148.04	3.4*1.8m	Orange	Each
CPC-0004	00.3797	1.74*1.74m	Light Green	Each
CPC-0005	00.2708	1.74*1.74m	Red	Each
CPC-0006	00.2707	1.74*1.74m	Green	Each
CPC-0014	32.3770.07	1.3*1.8m	Green	Each
CPC-0015	32.3770.05	2.0*1.8m	Green	Each
CPC-0016	32.3770.04	2.7*1.8m	Green	Each
CPC-0017	32.3770.03	3.4*1.8m	Green	Each

Welding Curtain Frame

CPC-0007

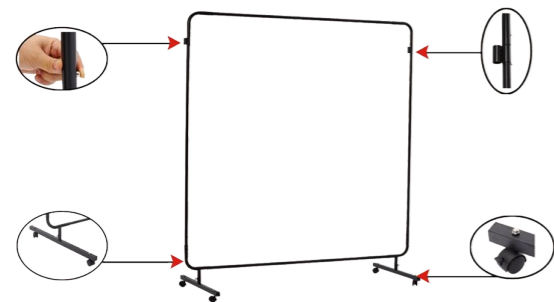

- Suits 1.74*1.74m welding curtain
- Durable black powder-coated round tube framing
- Snap-fit design for quick and easy assembly
- Lockable wheels for easy movement
- Welding curtain sold separately

SPECIFICATIONS

Model	ERP	Sizes(W*H)	Color	Unit
CPC-0007	00.3795	1.8*1.8m	Black	Each

ASSEMBLY INSTRUCTION

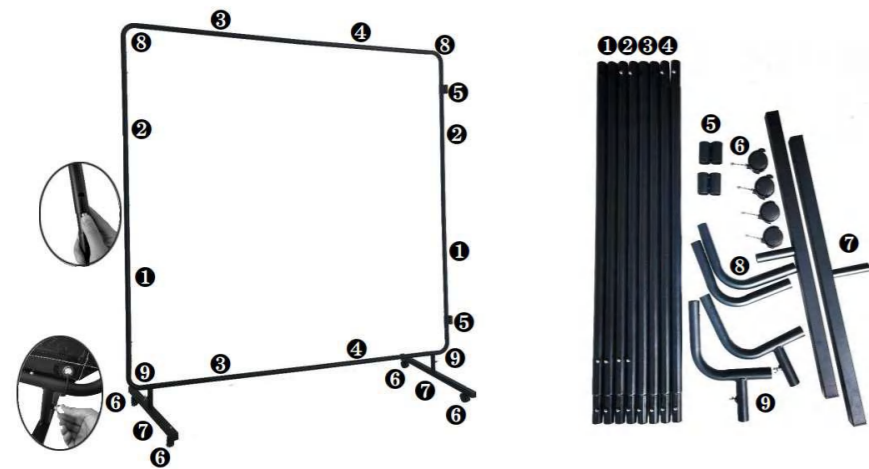

- 1 2. Side Poles *2*2.
- 3 4. Top & Bottom Poles *2*2.
- 5. Connectors *2.
- 6. Wheels *4 (2 Lockable).
- 7. Base Frames *2.
- 8. Up Corners *2.
- 9. Bottom Corners with screw *2.

Step A: Attach one lockable wheel (6) and one plain wheel (6) to each base frame (7).

Step B: Insert the bottom corners with screw (9) to each base frame (7), tighten the screws.

Step C: Insert pole (2) to pole (1) to make long side poles, adding connector (5); Insert pole (4) to pole (3) to make long top & bottom poles.

Step D: Insert long bottom pole, long side poles to bottom corners (9).

Step E: Insert long top pole to up corners (8), connect to side poles, adjust the bottom corners' screws as preference, this completes the assembly of the frame.

Step F: Attach matching welding curtain (sold separately).

We provide red, green, orange, clear colors for choice.

Welding Curtain and Frame Kit

- Flame resistant
- UV resistant
- Waterproof
- Anti-mildew
- Slip resistant
- Scuff resistant
- Chemical resistant
- Color Fade resistant
- Phthalate free
- Airtight etc.
- EN ISO 25980 Approved
- 16mil (0.4mm) specially formulated vinyl
- Snap-fit design for quick and easy assembly without tools



SPECIFICATIONS

Model	ERP	Sizes(W*H)	Color	Unit
CPC-0009	32.0136.01	1.2*1.5m	Red	Kit

Welding Curtain Bag

- Convenient, firm and durable
- Moisture and dustproof
- Comfortable handle design
- Transparent PVC Waterproof material
- Top zipper closure ensures safe and secure



SPECIFICATIONS

Model	ERP	Sizes(W*H)	Color	Unit
CPC-0008	32.0149	38*43cm	Black	Each

Laser safety room

Laser protective screen



- Product description of mobile laser protective plate;
- Mobile and highly flexible;
- The panel has been inspected by a professional organization;
- Modular design that can be assembled into various shapes;
- Lightweight and easy to disassemble and assemble;

Modle		Laser protective screen
Color		black
Thickness		4±0.2mm
Weight		4+0.2kg/m²
Structure		Three-layer aluminum panels
Features		High strength, low weight, corrosion resistance
Material		Aluminum material; The surface is resistant to high temperature paint treatment, and the paint is mixed with laser absorber
Test parameters	PEL	4000W/cm²
	Test wavelength	1080nm
	Spot diameter	3mm
	Test time	100s

Laser Safety Window



- Optical Density: 930-1030nm OD>6 1050 - 1100nm OD>7
- LB-Rating: >930-1050nm D AB6 + IR AB7,>1050-1100nm D AB5 +IR AB7
- Transmittance: 23%
- Standard size: 1000*1200mm, could be customized
- Thickness: 5mm
- Application: Fiber laser

Laser safety room

LP-CAB 2.0 (None)
Security interlock
Size: 2 * 2 * 2.1M
Laser protection board size and quantity: 400 * 600mm 5pcs
Material composition: Laser protective screen+Laser protective plate (LP LSs+IP YIW)

LP-CAB.R 2.0 (Has a top)
Security interlock
Size: 2 * 2 * 2.1M
Laser protection board size and quantity: 400 * 600mm 5pcs
Material composition: Laser protective screen+Laser protective plate (LP LSs+IP YIW)

LP-CAB 3.0 (None)
Security interlock
Size: 3 * 3 * 2.1M
Laser protection board size and quantity: 400 * 600mm 8pcs
Material composition: Laser protective screen+Laser protective plate (LP LSs+IP YIW)

LP-CAB.R 3.0 (Has a top)
Security interlock
Size: 3 * 3 * 2.1M
Laser protection board size and quantity: 400 * 600mm 8pcs
Material composition: Laser protective screen+Laser protective plate (LP LSs+IP YIW)



Welding Blanket Profile

Welding blankets are made of fiberglass fabric, silica fabric or fiberglass fabric with different kinds of coatings. The blankets provide excellent protection from grinding or welding sparks, slag and drops of molten metal, blankets also provide a safe and clean environment for welders. According to different materials, it has different temperature from 200°C to 1300°C , the specifications are customized according to needs.

Work Application

- Thinner and less heat resistant blankets are usually for light duty welding and cutting.
- Durable and higher heat resistant blanks are usually for heavy duty welding or cutting because of the drops of molten metals, etc.

Welding Blanket Materials

Fiberglass

Fiberglass is common used for MIG/TIG/MMA and plasma cutting processes, its heat resistance can be up to 1000 °C .



Uncoated fiberglass Acrylic coated fiberglass Vermiculite coated fiberglass

Silica Cloth

The silica is more than 96%, it is material with high resistance, it can be durable at 1000 °C for long time.

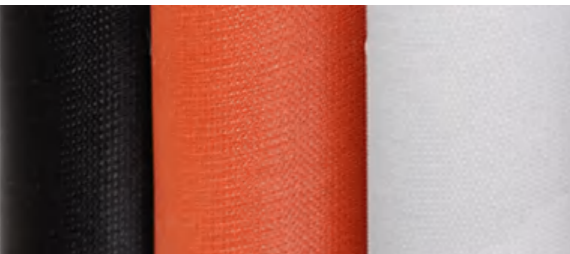

Carbon Fiber

Carbon Fiber has high heat resistance up to 1800 °C , it is soft, flexible and durable.



Welding blanket sizes, thickness and weight

- 1mx1m, 1mx2m, 2mx2m, other sizes can be made according to needs.
- Thickness can be 0.3mm to 3mm
- The weight can be from 100g to 860g

Welding Blanket

Fiberglass

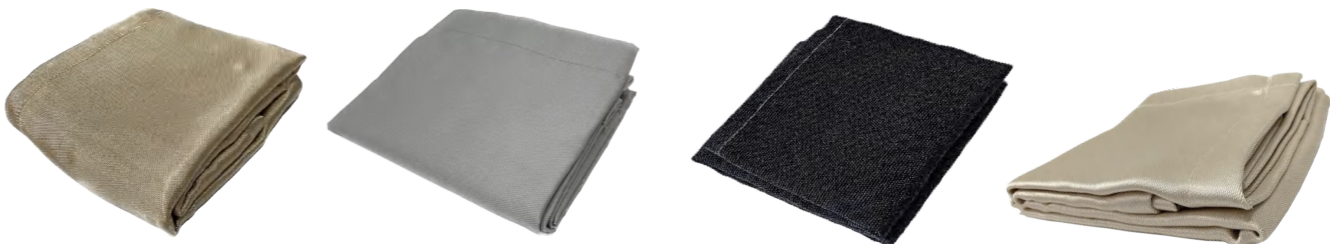

CPB-1850 CPB-3001 CPB-906 CPB-

SPECIFICATIONS

Model	Material	Max Temperature	Weight(g/m²)	Color	Size
CPB-1850	Uncoated fibreglass	550°C	620g	Tan	1*2m
					2*2m
CPB-3001	Acrylic coated fibreglass	550°C	460g	Grey	1*2m
					2*2m
CPB-906	Vermiculite coated fibreglass	750°C	750g	Black	1*2m
					2*2m
CPB-	Vermiculite coated fibreglass	900°C	700g	Bronze	1*2m
					2*2m

Silica Cloth



SPECIFICATIONS

Model	Material	Max Temperature	Weight(g/m²)	Color	Size
CPB-2-1900	Uncoated silica	1300°C	600g	Bronze	1*2m
					2*2m

Carbon Fiber



SPECIFICATIONS

Model	Material	Max Temperature	Weight(g/m²)	Color	Size
CPB-5180	Carbon fibre	1300°C	425g	Black	1*2m
					2*2m



Welding Fume Extractor advantages:

Healthy and Safety: Protects workers from inhaling harmful fumes, reducing the risk of respiratory diseases, cancer, and other health issues.

Regulatory compliance: Many jurisdictions have strict regulations regarding exposure to welding fumes. Using a fume extractor can help businesses comply with these regulations and avoid fines or legal issues.

Improved air quality: By removing welding fumes from the air, these extractors contribute to better indoor air quality in the workplace, creating a safer and more comfortable environment for everyone.

Enhanced productivity: Cleaner air and improved working conditions can lead to increased productivity among welders, as they can focus better and experience fewer health-related interruptions.

Overall, welding fume extractors provide a range of benefits that contribute to a safer, healthier, and more efficient workplace.

Welding Fume Extractors Profile

Welding Fume Extractors are critical for maintaining a safe and healthy work environment industries where welding is performed. They protect workers from hazardous fumes, improve air quality, and ensure compliance with safety standards. Their applications span across manufacturing, construction, aerospace, energy, and more, making them indispensable tools in modern industrial processes.

The Crepow Fume Extractors are designed special for welding, they are for extracting and filtering the harmful smoke from welding and cutting, providing safe working environment and efficient production environment.

We offer different models of fume extractors to fit your environment and fume control needs.

Welding Fume Extractor Features



Powerful extraction
Powerful extraction is fast solution for controlling welding fumes.



Convenient maintenance
Easy filter replacement is for ease of maintenance, some models included self-cleaning filter to clean filter automatically to extend filter life.



Longer filter life
Longer filter life with highly effectivity, efficiency and consistent filtration.



Pulse self-clean
Pulse self-clean mode keeps table in good working condition.



Easy to move
Compact design with wheels for ease of movement.



Good purification efficiency
Purification rate is up to 99.9%.



Sturdy construction
Rugged construction design for industry use, prevent melting and /or cracking over time.



Low noise
Noise reduction designed to operate at low noise levels, reducing workplace noise pollution.



Strong corrosion resistance
Corrosion resistance is suitable for use in corrosive environments, such as shipyards or chemical plants.



Good explosion-proof performance
Optional Explosion-Proof is suitable for environments with flammable gases or dust.

What are the Welding Fume Extractor applications?

- Trade show
 - Industry events
 - Manufacturing facilities
 - Automotive Industry
 - Construction and Infrastructure
- Aerospace Industry
 - Shipbuilding and Marine
 - Industry Laboratories and research facilities
 - Maintenance and Repair
 - Art and Sculpture
- Education and Training
 - DIY and home workshops
 - General Industry Applications

Application Cases





		FEX 1200	FEX 1200/1500/ 2400/3600(D)	FEX 2400/ 3600/4800Pro	FEX 1500/ 2400 i	FEX 180/245 /500 HNP	FEX 1500/ 2400ELS	FEX 1500/2400 /3600WM	FEX Laser 1/ Laser 2
Applications	Welding	■	■	■	■	■	■	■	
	Cutting	■	■	■	■	■	■	■	
	Polish	■	■	■	■	■	■	■	
	Grinding	■	■	■	■	■	■	■	
	Recycle of rare metal or precious material		■	■	■				
	Robot welding, handheld grinding					■			
	Oil mist						■		
	Small space with wall-mounted							■	
	Special for dust clean including laser and soldering welding and chemical								■
Filter Stages		2	3	3	3	3	3	2	3
Manual clean		■	Available	N/A	N/A	N/A	■	N/A	
Self-clean		N/A	Available	■	■	■	N/A	■	
Touch screen control		N/A	N/A	N/A	■	N/A	N/A	N/A	N/A
Button control		■	■	■	N/A	■	■	■	■
Single arm		■	■	■	■	■	■	■	■
Double arm		N/A	Optional	Optional	Optional	Optional	Optional	Optional	Optional

WELDING FUME EXTRACTORS INTERNAL STRUCTURE

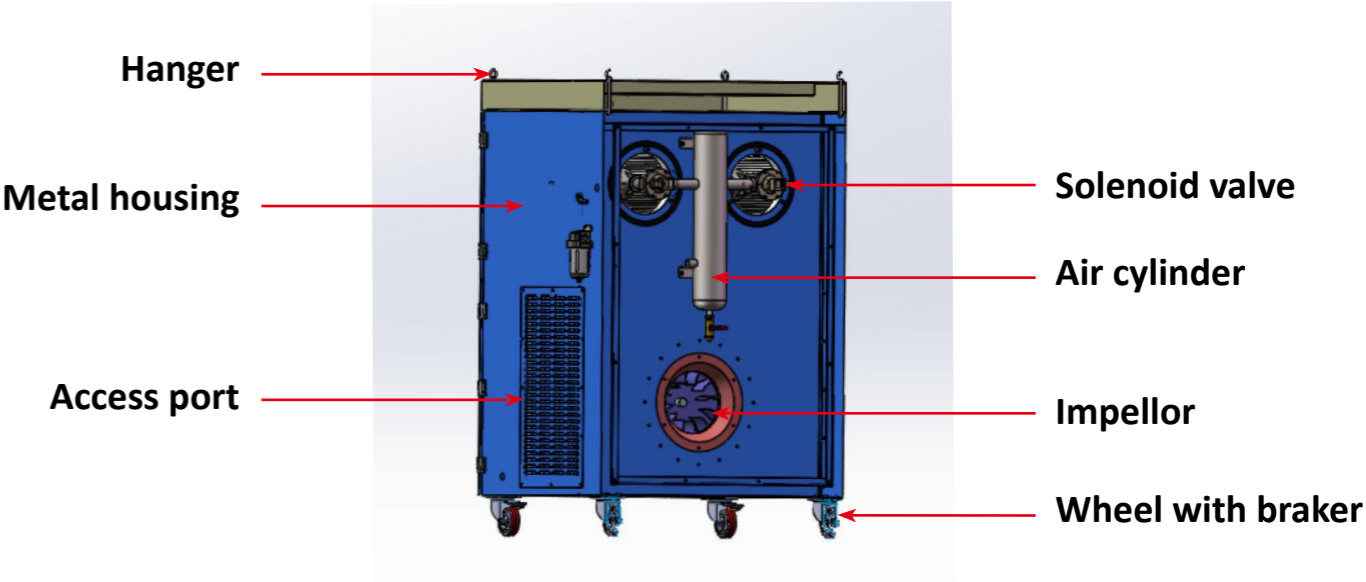
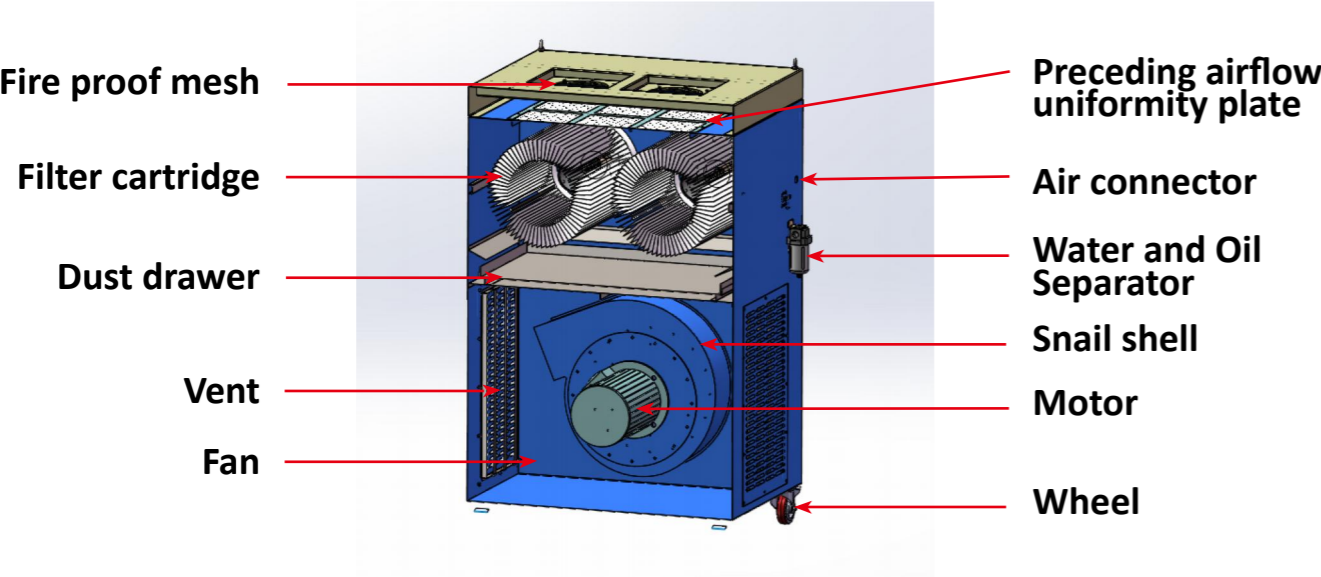

FEX 1200



Features

- Filter stages
- Manual clean
- Outstanding price-performance ratio
- 360° rotating exhaust hood
- Easy clean
- Stable performance
- ≥99.9% filter capacity

Applications

- Welding
- Cutting
- Polish
- Grinding

Modle	FEX 1200
FILTER	
Filter Stages	2
Filter Method	filter cartridge
Filter Surface	10m²
Type Of Filter	Filter Cartridge
Filter Material	PTFE coated polyester fiber
Filter Efficiency	≥99.9%
Filter class	Merv17
Additional Filters	Pre-Filter
TECHNICAL DATA	
Air Volume	1200m³/h
Motor Power	0.75kw
Power Supply	240V/ 50HZ
Noise Level In Field	≤75 db(A)
Clean Dust Method	Manual
Maximum Pressure	1700 pa
Compressed Air	
Flexible Arm Size	Ø 150*2000mm
Filter Size	Ø 380*425mm*1pc
Dimensions	530*640*1000mm
Weight	62kg

FEX 1200/1500/2400/3600 D



Features

- 3 Filter stages
- Self-clean
- 360° rotating exhaust hood
- Optional double arms
- Space-saving solution by two optional Extraction arms
- Safe operation by rotation field control
- Compact and solid design
- ≥99.9% filter capacity

Applications

- MIG/MAG solid wire welding
- MIG/MAG flux cored wire welding
- Electrode welding
- Gouging
- Cutting
- Grinding
- Polish

Modle	FEX 1200 D	FEX 1500 D	FEX 2400 D	FEX 3600 D
FILTER				
Filter Stages	3	3	3	3
Filter Method	filter cartridge	filter cartridge	filter cartridge	filter cartridge
Filter Surface	8m²	10m²	12m²	15m²
Type Of Filter	Filter Cartridge	Filter Cartridge	Filter Cartridge	Filter Cartridge
Filter Material	PTFE coated polyester fiber	PTFE coated polyester fiber	PTFE coated polyester fiber	PTFE coated polyester fiber
Filter Efficiency	≥99.9%	≥99.9%	≥99.9%	≥99.9%
Filter class	Merv17	Merv17	Merv17	Merv17
Additional Filters	Pre-Filter	Pre-Filter	Pre-Filter	Pre-Filter
TECHNICAL DATA				
Air Volume	1200m³/h	1500m³/h	2400m³/h	3600m³/h
Motor Power	1.1kw	1.5kw	2.2kw	3.0kw
Power Supply	380V/ 50HZ	380V/ 50HZ	380V/ 50HZ	380V/ 50HZ
Noise Level In Field	≤75 db(A)	≤75 db(A)	≤77 db(A)	≤80 db(A)
Clean Dust Method	Automatic/Manual	Automatic/Manual	Automatic/Manual	Automatic/Manual
Maximum Pressure	1700 pa	1700 pa	1700 pa	1700 pa
Compressed Air	0.4-0.6MPA	0.4-0.6MPA	0.4-0.6MPA	0.4-0.6MPA
Flexible Arm Size	Ø 160*2500mm	Ø 160*2500mm	Ø 160*2500mm	Ø 160*2500mm
Filter Size	Ø 325*465mm*1pc	Ø 325*465mm*1pc	Ø 325*465mm*1pc	Ø 325*465mm*1pc
Dimensions	650*600*1250mm/ 650*670*1250mm	650*600*1250mm/ 650*670*1250mm	650*600*1250mm/ 650*670*1250mm	650*600*1250mm/ 650*670*1250mm
Weight	130KG	130KG	135KG	140KG

FEX 2400/3600/4800 PRO



Features

- 3 Filter stages
- Self-clean
- 360° rotating exhaust hood
- Optional double arms
- Space-saving solution by two optional extraction arms
- Double cartridge filters
- Safe operation by rotation field control
- Compact and solid design
- ≥99.9% filter capacity

Applications

- MIG/MAG solid wire welding
- MIG/MAG flux cored wire welding
- Electrode welding
- Gouging
- Cutting
- Grinding
- Polish

Modle	FEX 2400 PRO	FEX 3600 PRO	FEX 4800 PRO
FILTER			
Filter Stages	3	3	3
Filter Method	filter cartridge	filter cartridge	filter cartridge
Filter Surface	16m²	20m²	24m²
Type Of Filter	Filter Cartridge	Filter Cartridge	Filter Cartridge
Filter Material	PTFE coated polyester fiber	PTFE coated polyester fiber	PTFE coated polyester fiber
Filter Efficiency	≥99.9%	≥99.9%	≥99.9%
Filter class	Merv17	Merv17	Merv17
Additional Filters	Pre-Filter	Pre-Filter	Pre-Filter

TECHNICAL DATA

Air Volume	2400m³/h	3600m³/h	4800m³/h
Motor Power	2.2kw	3.0kw	4.0kw
Power Supply	380V/ 50HZ	380V/ 50HZ	380V/ 50HZ
Noise Level In Field	≤80 db(A)	≤82 db(A)	≤83 db(A)
Clean Dust Method	Automatic	Automatic	Automatic
Maximum Pressure	1700 pa	1700 pa	1700 pa
Compressed Air	0.4-0.6MPA	0.4-0.6MPA	0.4-0.6MPA
Flexible Arm Size	Ø 160*2500mm	Ø 160*2500mm	Ø 160*2500mm
Filter Size	Ø 350*620mm*2pcs	Ø 350*620mm*2pcs	Ø 350*620mm*2pcs
Dimensions	920*920*1480mm	920*920*1480mm	920*920*1480mm
Weight	190+/- 5 KG	195+/- 5 KG	195+/- 5 KG

FEX 1500/2400 i



Features

- 3 Filter stages
- Self-clean
- Touch screen and PLC full-automatic control
- 360° rotating exhaust hood
- Optional double arms
- Space-saving solution by two optional extraction arms
- Double cartridge filters
- Safe operation by rotation field control
- Compact and solid design
- ≥99.9% filter capacity

Applications

- MIG/MAG solid wire welding
- MIG/MAG flux cored wire welding
- Electrode welding
- Gouging
- Cutting
- Grinding
- Polish

Modle	FEX 1500i	FEX 2400 i
FILTER		
Filter Stages	3	3
Filter Method	filter cartridge	filter cartridge
Filter Surface	10m²	20m²
Type Of Filter	Filter Cartridge	Filter Cartridge
Filter Material	PTFE coated polyester fiber	PTFE coated polyester fiber
Filter Efficiency	≥99.9%	≥99.9%
Filter class	Merv17	Merv17
Additional Filters	Pre-Filter	Pre-Filter

TECHNICAL DATA

Air Volume	1500m³/h	2400m³/h
Motor Power	1.5kw	3.0kw
Power Supply	415V/ 50HZ 3 Phase	415V/ 50HZ 3 Phase
Noise Level In Field	≤85 db(A)	≤85 db(A)
Clean Dust Method	Automatic	Automatic
Maximum Pressure	1700 pa	1700 pa
Compressed Air	0.4-0.6MPA	0.4-0.6MPA
Flexible Arm Size	Ø 150*3000mm	Ø 150*3000mm
Filter Size	Ø 325*660mm*1pc	Ø 325*660mm*1pc
Dimensions	700*760*1460mm	700*760*1460mm
Weight	185 +/- 5 KG	200 +/- 10 KG

FEX 190/245/500 HNP



Features

- 2 Filter stages
- Self-clean
- High negative pressure
- Safe operation by rotation field control
- Compact and solid design
- ≥99.9% filter capacity

Applications

- MIG/MAG solid wire welding
- MIG/MAG flux cored wire welding
- Electrode welding
- Robot welding
- Gouging
- Cutting
- Grinding
- Polish

Modle	FEX 190 HNP	FEX 245 HNP	FEX 500 HNP
FILTER			
Filter Stages	3	3	3
Filter Method	filter cartridge	filter cartridge	filter cartridge
Filter Surface	8m²	10m²	12m²
Type Of Filter	Filter Cartridge	Filter Cartridge	Filter Cartridge
Filter Material	PTFE coated polyester fiber	PTFE coated polyester fiber	PTFE coated polyester fiber
Filter Efficiency	≥99.9%	≥99.9%	≥99.9%
Filter class	Merv17	Merv17	Merv17
Additional Filters	Pre-Filter	Pre-Filter	Pre-Filter
TECHNICAL DATA			
Air Volume	190m³/h	245m³/h	500m³/h
Motor Power	1.5kw	3.0kw	5.5kw
Power Supply	380V/50HZ or customized	380V/50HZ or customized	380V/50HZ or customized
Noise Level In Field	≤80 db(A)	≤82 db(A)	≤85 db(A)
Clean Dust Method	Automatic	Automatic	Automatic
Maximum Pressure	23000 pa	32000 pa	36000 pa
Compressed Air	0.4-0.6MPA	0.4-0.6MPA	0.4-0.6MPA
Flexible Arm Size	Ø 50*10000mm	Ø 50*10000mm	Ø 50*10000mm
Filter Size	Ø 210*362mm*2pcs	Ø 210*362mm*2pcs	Ø 210*362mm*3pcs
Dimensions	550*550*1110mm	620*600*1180mm	750*700*1280mm
Weight	100 +/- 10 KG	110 +/- 10 KG	130 +/- 10 KG

FEX 1500/2400 ELS



Features

- Electrostatic
- 3 Filter stages
- Less noise
- Energy saving
- 360° rotating exhaust hood
- Easy maintenance
- Easy clean
- ≥99.9% filter capacity

Applications

- Oil mist
- Welding
- Cutting
- Polish
- Grinding

Modle	FEX 1500 ELS	FEX 2400 ELS
FILTER		
Filter Stages	3	3
Filter Method	Electrostatic module	Electrostatic module
Filter Surface	10m²	12m²
Type Of Filter	High voltage	High voltage
Filter Material	Static electric field of aviation aluminum alloy	Static electric field of aviation aluminum alloy
Filter Efficiency	≥99.9%	≥99.9%
Filter class	Merv17	Merv17
Additional Filters	Pre-Filter	Pre-Filter
TECHNICAL DATA		
Air Volume	1500m³/h	2400m³/h
Motor Power	1.5kw	3.0kw
Power Supply	380V/50Hz	380V/50Hz
Noise Level In Field	≤80 db(A)	≤83 db(A)
Clean Dust Method	Manual	Manual
Maximum Pressure	1700 pa	1700 pa
Compressed Air		
Flexible Arm Size	Ø 150*2500mm	Ø 150*2500mm
Filter Size	500*500mm*1pc	500*500mm*1pc
Dimensions	600*580*1250mm	650*670*1325mm
Weight	130 +/- 10 KG	130 +/- 10 KG

FEX 1500/2400/3600 WM



Features

- Wall-mounted , space saving solution
- 360° rotating exhaust hood
- Less noise
- Compact size, less power, energy saving

Applications

- Training school or welding shop with small space
- Welding
- Cutting
- Polish
- Grinding

Modle	FEX 1500 WM	FEX 2400 WM	FEX 3600 WM
-------	-------------	-------------	-------------

FILTER			
Filter Stages	2	2	2
Filter Method	filter cartridge	filter cartridge	filter cartridge
Filter Surface	7m²	8m²	10m²
Type Of Filter	Filter Cartridge	Filter Cartridge	Filter Cartridge
Filter Material	Pre-Coating Polyester	Pre-Coating Polyester	Pre-Coating Polyester
Filter Efficiency	≥99.9%	≥99.9%	≥99.9%
Filter class	Merv17	Merv17	Merv17
Additional Filters	Pre-Filter	Pre-Filter	Pre-Filter

TECHNICAL DATA			
Air Volume	1500m³/h	2400m³/h	3600m³/h
Motor Power	1.5kw	2.2kw	3.0kw
Power Supply	380V/50HZ	380V/50HZ	380V/50HZ
Noise Level In Field	≤75 db(A)	≤80 db(A)	≤82 db(A)
Clean Dust Method	Automatic	Automatic	Automatic
Maximum Pressure	1700 pa	1700 pa	1700 pa
Compressed Air	0.4-0.6MPA	0.4-0.6MPA	0.4-0.6MPA
Flexible Arm Size	Ø 150*2500mm	Ø 150*2500mm	Ø 150*2500mm
Filter Size	Ø 325*620mm*1pc	Ø 325*620mm*1pc	Ø 325*620mm*1pc
Dimensions	968*710*1033mm	968*710*1033mm	968*710*1112mm
Weight	110 +/- 10 KG	120 +/- 10 KG	130 +/- 10 KG

FEX Laser 1/2



Features

- Special for soldering and laser fume
- 3 Filters （Pre filter, middle filter and Main filter）
- All in one design
- Easy operation
- Large power DC brushless motor
- Adjustable air flow
- Built-in fume filter and recycle
- Multi station design
- Less noise
- ≥99.9% filter capacity

Applications

- Laser welding
- Laser marking
- Laser engraving
- Laser cutting
- Chemical lab
- Medical treatment and beauty and so on
- Soldering

Modle	FEX Laser 1	FEX Laser 2
-------	-------------	-------------

FILTER		
Filter Stages	3	3
Filter Method	filter cartridge	filter cartridge
Filter Surface		
Type Of Filter	Filter Cartridge	Filter Cartridge
Filter Material	Pre-Coating Polyester	Pre-Coating Polyester
Filter Efficiency	≥99.9%	≥99.9%
Filter class	Merv17	Merv17
Additional Filters	Pre-Filter	Pre-Filter

TECHNICAL DATA		
Air Volume	200m³/h	320m³/h
Motor Power	0.12kw	0.25kw
Power Supply	220V/50HZ	220V/50HZ
Noise Level In Field	≤ 75 db	≤ 75 db
Clean Dust Method		
Maximum Pressure	700 pa	700 pa
Compressed Air		
Flexible Arm Size	Ø 75*1500mm	Ø 75*1500mm
Filter Size	365*175mm*3pcs	365*175mm*3pcs
Dimensions	400*230*350mm	470*230*500mm
Weight	7.8kg	15.5kg

FUME EXTRACTION ARM



FEX-WM

FEX-WM wall-mounted flexible suction arm

Length	2m, 3m, 4m
Diameter	150mm, 160mm ,200mm.
Material of outer pump	Imported PVC steel wire pipe
Frame materials	The spring is made of carbon steel, other metal parts are 304# stainless steel.



FEX-GN

FEX-GN fume extraction arm

Length	2m, 3m, 4m
Diameter	160mm
Frame materials	Imported PVC steel wire pipe



FEX-MB

Flexible suction arm for FEX-MB equipment

Length	2m, 3m, 4m
Diameter	150mm, 160mm ,200mm.
Outer pipe material	Imported PVC steel wire pipe
Frame materials	The spring is made of carbon steel, other metal parts are 304# stainless steel.



FEX-Laser

FEX-Laser suction arm

Length	40mm
Diameter	70mm

Accessory



Hood

Length	150mm interface
Material	Plastic



Protective mesh

Protection mesh fro exhaust hood



Replacement hose

Specifications	150mm; 200mm; 250mm; 300mm
Material	Ordinary flame retardant hose, high temperature flame retardant hose



Filter

Specifications	210mm; 325mm; 350mm
Material	PTFE coated polyester



Downdraft table advantages:

- Improved air quality: Reduces airborne contaminants, protecting workers' health.
- Cleaner workspace: Keeps the work area free of debris.
- Compliance: Helps meet occupational safety and health regulations.
- Versatility: Suitable for a wide range of materials and processes.

Downdraft tables are essential in environments where air quality and cleanliness are critical, ensuring a safer and more efficient workspace.

Welding Downdraft table Profile

A downdraft table is a specialized work surface used primarily in industrial environments to capture and remove dust, fumes, and debris generated during operations like sanding, cutting, grinding, or welding. It features a perforated tabletop and a built-in ventilation system that pulls air downward through the table, effectively capturing contaminants before they can disperse into the surrounding air.

What are the Welding Downdraft table applications?

- **Metalworking:** Removes metal shavings and welding fumes during welding, cutting and sanding.
- **Composite Material Work:** Handles fine dust from materials like fiberglass or carbon fiber.
- **General Manufacturing:** Used for tasks that generate airborne particles.

Welding Downdraft table Features



Perforated surface

The tabletop has small holes or slots to allow air to flow through.



In good working condition

Pulse self-clean mode keeps table in good working condition.

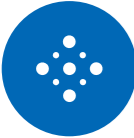

Dust-removal system

Build-in dust-removal system



Work conveniently and quickly

Clean dust is easy ad fast by flue-dust container.



High efficiency centrifugal fan

It creates a downdraft, pulling particles and fumes into a collection system, and keep running stable.



Noise reduction design

It operates at low noise levels, reducing workplace noise pollution.



Filtration system

Captured contaminants are filtered by HEPA filters, to clean the air before it is recirculated or exhausted.



Work surface

Provides a stable area for tasks like welding, cutting, or sanding.



Explosion proof type

Optional Explosion-Proof is suitable for environments with flammable gases or dust.

DDTM 2400/3000/5000/6500



DDTM 2400

Input voltage	3phs 380V 50Hz
Air flow(m³/h)	2400
Motor size(kw)	2.2
Size of filter(mm)	Φ325*1020
Filter quantity(pc)	2
Clean system	Pulse cleanng
Fan	Centrifugal
Overall dimensions(L*W*H)mm	2000*950*1200
Table height(mm)	900
Thickness of body(mm)	2-3
Thickness of table top(mm)	5
Load capacity(kg)	500
Remarks	Downdraft

DDTM 5000

Input voltage	3phs 380V 50Hz
Air flow(m³/h)	5000
Motor size(kw)	2.2*2
Size of filter(mm)	Φ325*770
Filter quantity(pc)	4
Clean system	Pulse cleanng
Fan	Centrifugal
Overall dimensions(L*W*H)mm	2200*1050*1350
Table height(mm)	950
Thickness of body(mm)	2-3
Thickness of table top(mm)	5
Load capacity(kg)	500
Remarks	Downdraft

DDTM 3000

Input voltage	3phs 380V 50Hz
Air flow(m³/h)	3000
Motor size(kw)	4
Size of filter(mm)	Φ325*1200
Filter quantity(pc)	2
Clean system	Pulse cleanng
Fan	Centrifugal
Overall dimensions(L*W*H)mm	2200*1100*1200
Table height(mm)	900
Thickness of body(mm)	2-3
Thickness of table top(mm)	5
Load capacity(kg)	500
Remarks	Downdraft

DDTM 6500

Input voltage	3phs 380V 50Hz
Air flow(m³/h)	6500
Motor size(kw)	4.0*2
Size of filter(mm)	Φ325*920
Filter quantity(pc)	4
Clean system	Pulse cleanng
Fan	Centrifugal
Overall dimensions(L*W*H)mm	2200*1200*1350
Table height(mm)	950
Thickness of body(mm)	2-3
Thickness of table top(mm)	5
Load capacity(kg)	500
Remarks	Downdraft

DDTK 5000/6500



DDTK 5000

Input voltage	3phs 380V 50Hz
Air flow(m³/h)	5000
Motor size(kw)	2.2*2
Size of filter(mm)	Φ325*770
Filter quantity(pc)	4
Clean system	Pulse cleanng
Fan	Centrifugal
Overall dimensions(L*W*H)mm	2200*1050*1550
Table height(mm)	950
Thickness of body(mm)	2-3
Thickness of table top(mm)	5
Load capacity(kg)	500
Remarks	Downdraft+side

DDTK 6500

Input voltage	3phs 380V 50Hz
Air flow(m³/h)	6500
Motor size(kw)	4.0*2
Size of filter(mm)	Φ325*920
Filter quantity(pc)	4
Clean system	Pulse cleanng
Fan	Centrifugal
Overall dimensions(L*W*H)mm	2200*1200*1550
Table height(mm)	950
Thickness of body(mm)	2-3
Thickness of table top(mm)	5
Load capacity(kg)	500
Remarks	Downdraft+side

DDTG 3000



DDTG 3000

Input voltage	3phs 380V 50Hz
Air flow(m³/h)	3000
Motor size(kw)	3
Size of filter(mm)	Φ325*465
Filter quantity(pc)	2
Clean system	Pulse cleanng
Fan	Centrifugal
Overall dimensions(L*W*H)mm	1200*800*1470
Table height(mm)	860
Thickness of body(mm)	2-3
Thickness of table top(mm)	5
Load capacity(kg)	500
Remarks	Downdraft

DDTJ 2400/3000



DDTJ 2400

Input voltage	3phs 380V 50Hz
Air flow(m³/h)	2400
Motor size(kw)	2.2
Size of filter(mm)	Φ325*465
Filter quantity(pc)	2
Clean system	Pulse cleanng
Fan	Centrifugal
Overall dimensions(L*W*H)mm	1000*1360*1640
Table height(mm)	880
Thickness of body(mm)	2-3
Thickness of table top(mm)	5
Load capacity(kg)	500
Remarks	Downdraft+side

DDTJ 3000

Input voltage	3phs 380V 50Hz
Air flow(m³/h)	3000
Motor size(kw)	3
Size of filter(mm)	Φ325*495
Filter quantity(pc)	2
Clean system	Pulse cleanng
Fan	Centrifugal
Overall dimensions(L*W*H)mm	1000*1360*1640
Table height(mm)	880
Thickness of body(mm)	2-3
Thickness of table top(mm)	5
Load capacity(kg)	500
Remarks	Downdraft+side

